

DATE	REVISION	REVISED BY	L.S. NO.
2012	Major Sub. Block 312 Lots 14.01-14.04	J.D. BERGLER	37181
2013	Minor Sub. Block 312 lots 18.01,18.03	J.D. BERGLER	37181
2013	312/21.01 RD Widening	J.D. BERGLER	37181
2014	Modify lot dim. 312/21.06,21.07	J.D. BERGLER	37181



MIDDLESEX COUNTY
IRELANDS BROOK PARK
(EXEMPTED)

BLOCK	LOT
312	7.02,9.02
	10.02,11.02
	12.02,13.02
	16.02,17.02
	18.02,19.02
	20.02,21.04
	21.05,22.23

MIDDLESEX COUNTY
EXEMPTED

BLOCK	LOT
310	75,76.08,77
	79,80,81,82

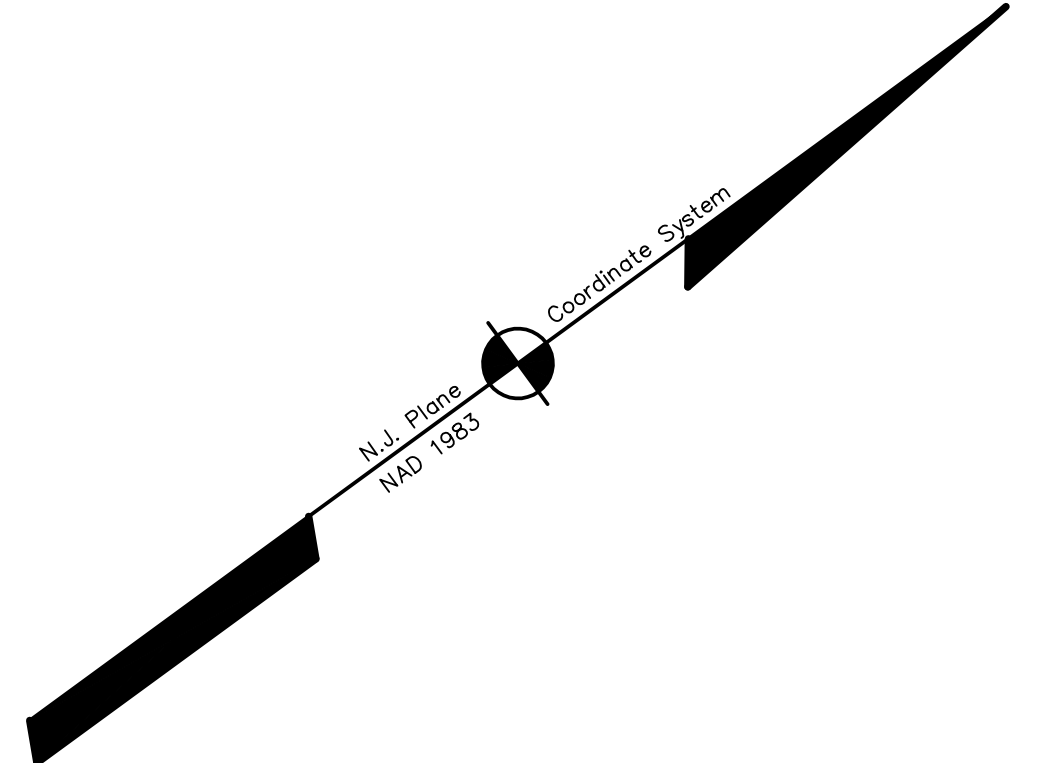

ADJOINS SHEET NO. 33

NEW JERSEY DEPARTMENT OF THE TREASURY
DIVISION OF TAXATION
PROPERTY ADJUSTMENT
APPROVED AS A TAX MAP PURSUANT TO THE AUTHORITY OF
N.J.S.A. 54:15 & 54:16
FOR THE DIRECTOR, DEPARTMENT OF REVENUE
JAMES J. COLLETT, LOCAL ASSESSMENT COMPLIANCE C.T.A.
SANTA C. DODD, REPRESENTING FIELD REPRESENTATIVE C.T.A.
DATE: DEC 20 2004 SERIAL NO. 852

THIS MAP HAS BEEN DRAWN USING COMPUTER AIDED
DRAFTING/DESIGN (CAD/D) AND COORDINATE
GEOMETRY (COGO)

TAX MAP
EAST BRUNSWICK TOWNSHIP
MIDDLESEX COUNTY, NEW JERSEY
SCALE: 1" = 200' DATE :5-1-2003
JOHN D. BERGLER
LICENSED LAND SURVEYOR No. 37181
195 WASHINGTON ROAD
SAYREVILLE, NEW JERSEY

ADJOINS SHEET NO. 34 & 35