

DATE	REVISION	REVISED BY	L.S. NO.
2006	HOUSE NUMBERS, widening CULVER LANE	J.D. BERGLER	37181

BOROUGH OF SOUTH RIVER



ADJOINS SHEET NO. 22.03

ADJOINS SHEET NO. 22.02

BOROUGH OF SOUTH RIVER

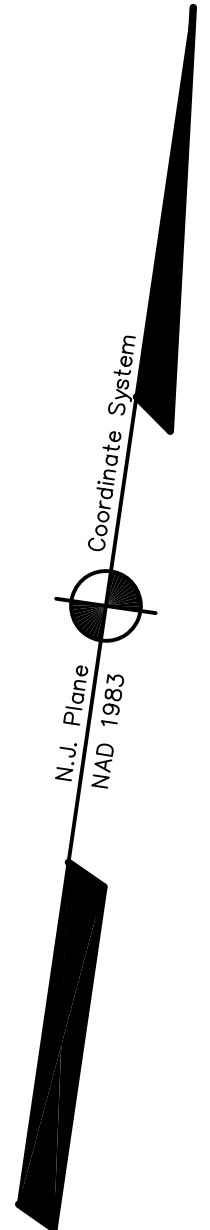

THIS MAP HAS BEEN DRAWN USING COMPUTER AIDED DRAFTING/DESIGN (CAD/D) AND COORDINATE GEOMETRY (COGO)

NEW JERSEY DEPARTMENT OF THE TREASURY
 DIVISION OF TAXATION
 PROPERTY ADMINISTRATION
 APPROVED AS A TAX MAP PURSUANT TO THE AUTHORITY OF
 N.J.A.C. 17:27 & 17:28
 FOR THE DIRECTOR, DIVISION OF TAXATION
James J. ... C.T.A.
 COUNTY & LOCAL ASSESSMENT COMPLIANCE
John D. Bergler C.T.A.
 DATE: DEC 20 2004 SERIAL NO. 852

TAX MAP
EAST BRUNSWICK TOWNSHIP
MIDDLESEX COUNTY, NEW JERSEY
 SCALE: 1" = 100' DATE : 5-1-2003
JOHN D. BERGLER
 LICENSED LAND SURVEYOR No. 37181
 195 WASHINGTON ROAD
 SAYREVILLE, NEW JERSEY