

ADJOINS SHEET NO. 18.02

ADJOINS SHEET NO. 18.11

ADJOINS SHEET NO. 24.01



88.21
1.01
3.52Ac.(TOTAL)

88.20
1.01
4.52Ac.(TOTAL)

NEW JERSEY DEPARTMENT OF THE TREASURY
DIVISION OF TAXATION
PROPERTY ADVERTISEMENT
APPROVED AS A TAX MAP PURSUANT TO THE AUTHORITY OF
N.J.A.C. 17:27 & 17:28
FOR THE DIRECTOR, DIVISION OF TAXATION
James G. ... C.T.A.
Scott G. ... C.T.A.
DATE: DEC 20 2004 REG. NO. 852

THIS MAP HAS BEEN DRAWN USING COMPUTER AIDED DRAFTING/DESIGN (CAD/D) AND COORDINATE GEOMETRY (COGO)

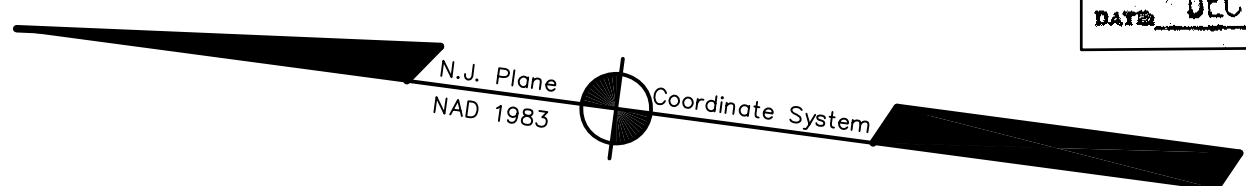

TAX MAP
EAST BRUNSWICK TOWNSHIP
MIDDLESEX COUNTY, NEW JERSEY
SCALE: 1"=30' DATE: 5-1-2003
JOHN D. BERGLER
LICENSED LAND SURVEYOR No. 37181
195 WASHINGTON ROAD
SAYREVILLE, NEW JERSEY

ADJOINS SHEET NO. 18