

ADJOINS SHEET NO. 10

BOROUGH

RYDERS CROSSING BLOCK

OF

(COUNTY ROAD #917)

MUNICIPAL BOUNDARY LINE

MILLTOWN

LANE

LANE

LANE

84.01

84.04

84.02

84.03

84.04

621

625

628

629

630

COUNTRY LANE HOMES SEC. 4

COUNTRY LANE HOMES SEC. 3

RYDERS CROSSING

BEARSLEY DRIVE

STRATFORD

BUSH

VICTORY PLACE

PKWY

BELL CT.

DEAN N.

WEST ZOLLER RD.

EAST ZOLLER RD.

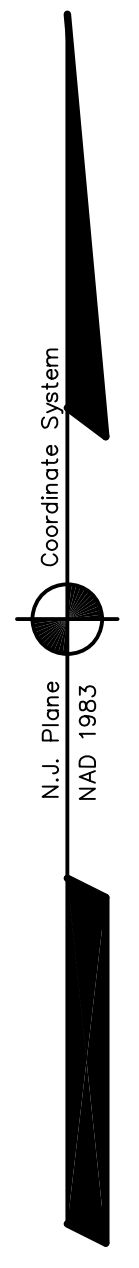

ADJOINS SHEET NO. 12.03

THIS MAP HAS BEEN DRAWN USING COMPUTER AIDED DRAFTING/DESIGN (CAD/D) AND COORDINATE GEOMETRY (COGO)

NEW JERSEY DEPARTMENT OF THE TREASURY
DIVISION OF TAXATION
PROPERTY ALLOCATION
APPROVED AS A TAX MAP PURSUANT TO THE AUTHORITY OF
N.J.A.C. 17:27-15 & 17:27-16
FOR THE DIRECTOR, DIVISION OF TAXATION
[Signature]
SERIES C. H. 1000-2
DATE: DEC 20 2004 SERIAL NO. 852

TAX MAP
EAST BRUNSWICK TOWNSHIP
MIDDLESEX COUNTY, NEW JERSEY
SCALE: 1"= 100' DATE :5-1-2003
JOHN D. BERGLER
LICENSED LAND SURVEYOR No. 37181
195 WASHINGTON ROAD
SAYREVILLE, NEW JERSEY

ADJOINS SHEET NO. 12.02