

DATE	REVISION	REVISED BY	L.S. NO.
2020	r.o.w. widening, 87/5.01,5.02	J.D. BERGLER	37181

ADJOINS SHEET NO. 16.01&16.02



ADJOINS SHEET NO. 41.01

ADJOINS SHEET NO. 17.02&17.03

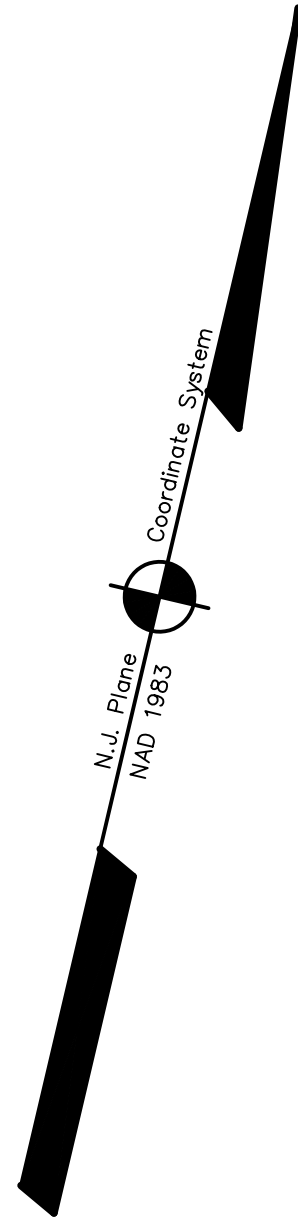

THIS MAP HAS BEEN DRAWN USING COMPUTER AIDED DRAFTING/DESIGN (CAD/D) AND COORDINATE GEOMETRY (COGO)

NEW JERSEY DEPARTMENT OF THE TREASURY
 DIVISION OF TAXATION
 PROPERTY ADMINISTRATION
 APPROVED AS A TAX MAP PURSUANT TO THE AUTHORITY OF
 N.J.A.C. 17:27 & 17:28
 FOR THE DIRECTOR, DIVISION OF TAXATION
James J. Cole C.T.A.
 JAMES J. COLE, CHIEF, LOCAL ASSESSMENT COMPLIANCE
Santo C. DiMarco C.T.A.
 SANTO C. DIMARCO, ASSISTANT FIELD REPRESENTATIVE
 DATE: DEC 20 2004 SERIAL NO. 852

TAX MAP
EAST BRUNSWICK TOWNSHIP
MIDDLESEX COUNTY, NEW JERSEY

SCALE: 1"= 100' DATE :5-1-2003

JOHN D. BERGLER

LICENSED LAND SURVEYOR No. 37181
195 WASHINGTON ROAD
SAYREVILLE, NEW JERSEY

ADJOINS SHEET NO. 17